



Project: \_\_\_\_\_

Type: \_\_\_\_\_

Notes: \_\_\_\_\_

**EZT** | The EZT System, with multiple lensing options, provides an EZT and versatile way to integrate lines or shapes of light into a T-Grid or drywall ceiling. Create unique layouts by forming shapes like squares, rectangles, L's, or straight lengths with no limitation to main or cross tbars as the fixture simply fastens to the bottom of any grid system or magnetically mounts to drywall ceilings. Also available for pendant mounting.



## Ordering Guide

EZTX							
ARON ID		CEILING TYPE	LENGTH		LUMENS/FT		
EZT1	EZTV1	F9	Flat 9/16" Tbars w/ Flat Acoustical Panel	2FA	2FT	300	300 lm/ft
		F15	Flat 15/16" Tbars w/ Flat Acoustical Panel			400	400 lm/ft
		FT9	Flat 9/16" Tbars w/ Regular Acoustical Panel	4FA	4FT	500	500 lm/ft
		FT15	Flat 15/16" Tbars w/ Regular Acoustical Panel	6FA	6FT	750	750 lm/ft
		SS	Dimensional 9/16" Bolt Slot Tbars	8FA	8FT	850	850 lm/ft
		GYP	Hard Lid Ceiling Surface Mount - Magnet Mounting	X	2'x2', 4'x4', 2'x4'...	1000	1000 lm/ft
		FM	T-Grid - Magnet Mounting	C	Continuous Run: *1ft Increments		
		FTM	Regular Tile - Magnet Mounting				
		WS	Wood Slat - Magnet Mounting				
					*For Corners or U Shapes, Specify L for Corner, U for U shapes (EX. ...2'x2'L...)		*Consult Factory for Other Lumen Packages *Wattage Calculated w/ CCT of 35K8

		UNV					
BEAM		COLOR / CRI	VOLTAGE	DRIVER		ACCESSORIES/RATINGS	
B1	3 Sided Diffusion	30K8 3000K - 80CRI	UNV 120-277V	DM	Factory 0-10V, Dim 1%	E5W	5W EM Battery
B2	Direct Only	30K9 3000K - 90CRI	347 347 V	BT	Bluetooth	E10W	10W EM Battery
B3	Louvers	35K8 3500K - 80CRI		ELD	EldoLED .1% Dimming		
B4	Wallwash	35K9 3500K - 90CRI			*contact factory for other driver, dimming and control options		
		40K8 4000K - 80CRI					
		40K9 4000K - 90CRI					
		TW Tunable White					
				**See Page 5 for Bluetooth Information. Consult Factory			

## Dimensions

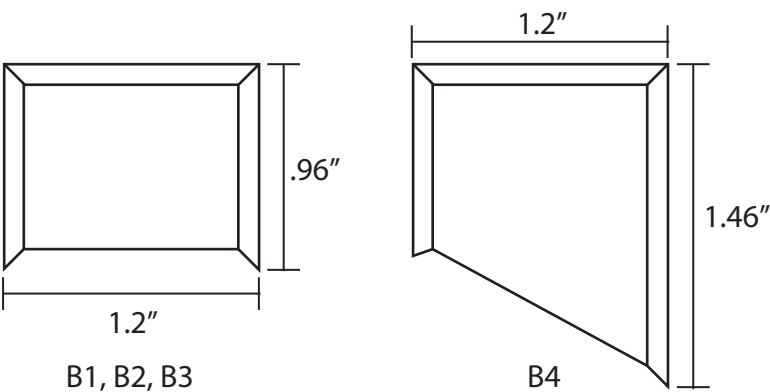

## Continuous Runs & Shapes:

Available at any length, with diffuse joiner for continuous line of light.

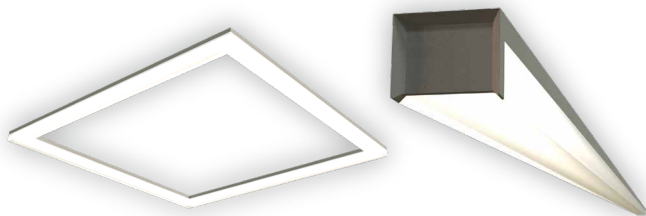

## Application Sizes

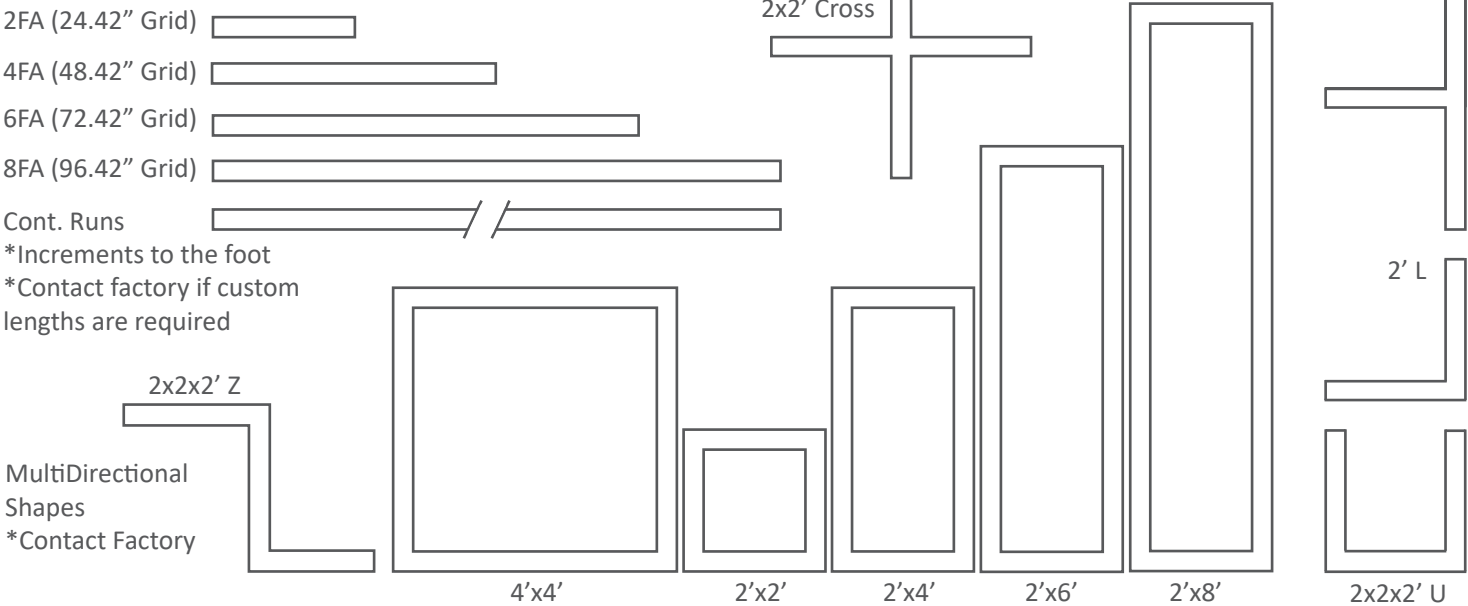

## Construction

- Lens: Extruded Volumetric Diffusion Lens
- End Cap: Die Cast Aluminum
- Fixture Housing: Extruded Aluminum, powder coated
- Sheet Metal: Galvanized 18 gauge remote driver box
- Mounting: TGrid Sheet Metal Clip or Drywall Anchors w/ Sheet Metal Attachment Plate
- Joiner: Volumetric Injection Molded Diffuse Material

## Optical

- Symmetric Lambertian and Asymmetric Distributions
- Extruded Volumetric Diffusion Lenses
- Minimum 80 or 90 CRI
- 3000K, 3500K, 4000K
- ≤ 3 SDCM

## Mounting:

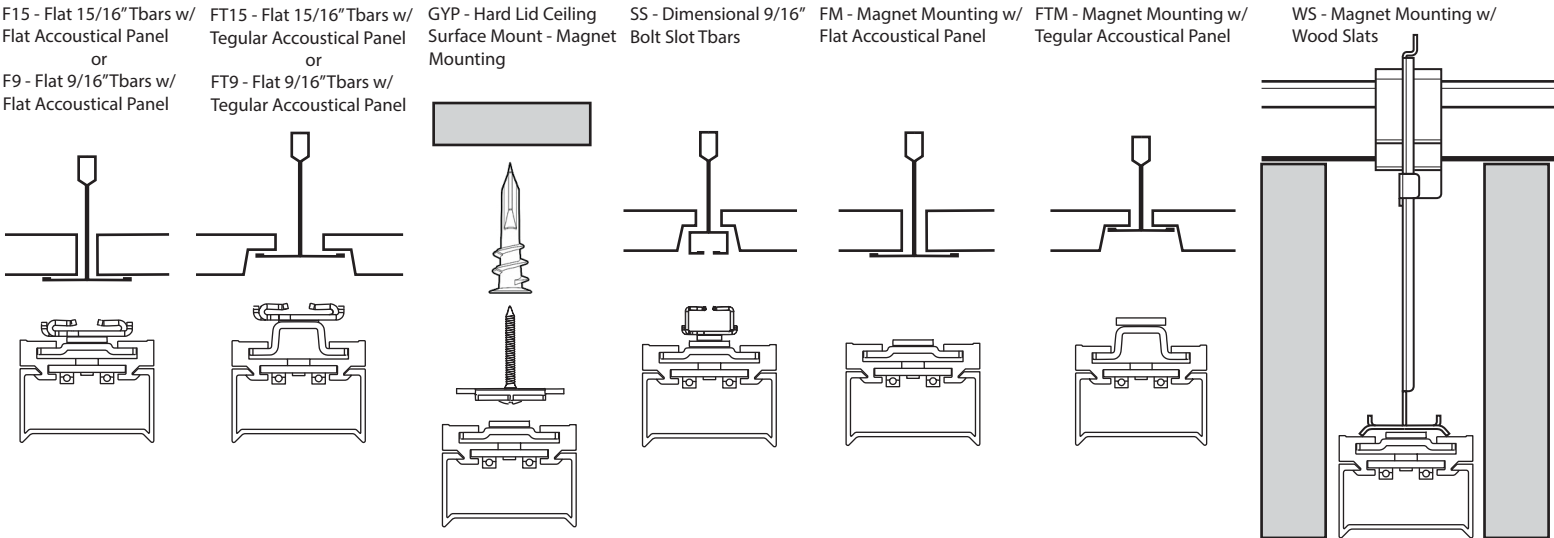

## Electrical

- Remote high efficiency driver w/ universal 120-277 input
- 0-10V dimming (1%) standard
- Class 2
- Optional Integral battery pack
- L90: 90,000 Hours
- L70: 185,000 Hours
- Various Control and Driver Options
- \*Contact factory

## Mechanical Joining



## Remote Kit Options

### LOW PROFILE REMOTE DRIVER BOX MAX DRIVER SIZE 25W

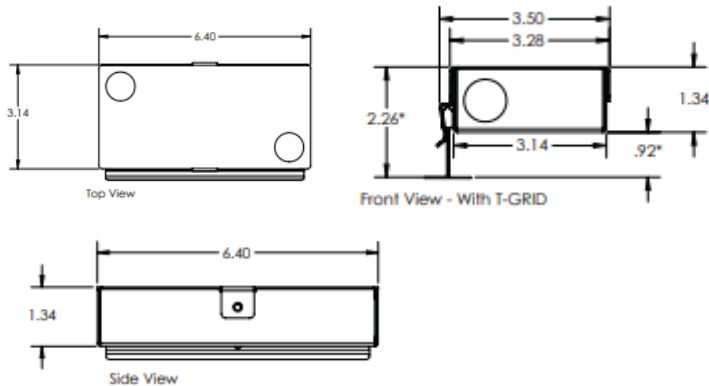

### STANDARD REMOTE DRIVER BOX MAX DRIVER SIZE 95W

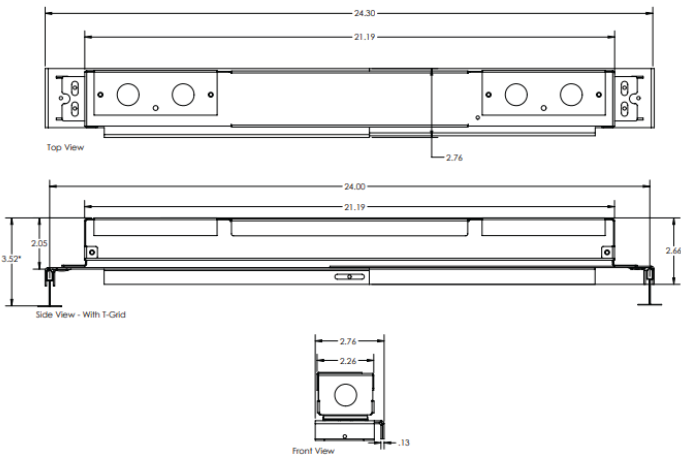

## Model Tested: EZT-FT15-4FA-1000-B1-35K8-UNV-DM-W

### Photometric Curve

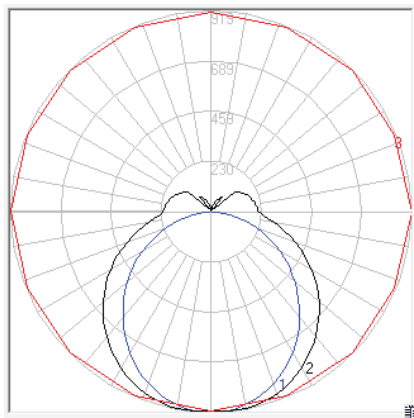

**Length: 4ft**  
**Lumens/ft: 878.5**  
**Total Lumens: 3513.8**  
**Input Watts: 27.74 W**  
**Efficacy: 126.7 lm/W**

### Candela Distribution

#### Luminance Data [cd/sq.m]

Angle In Degrees	Average 0-Deg	Average 45-Deg	Average 90-Deg
45	21303	18184	17680
55	19967	16537	16175
65	18097	14741	14545
75	14326	12483	12653
85	7935	10234	11172

### Wattage/ft

Lumens/ft	Watts/ft
300	2.37W
400	3.16W
500	3.95W
750	5.92W
850	6.71W
1000	7.89W

### Zonal Lumens

Zone	Lumens	%Lamp	%Fixt
0-20	336.99	N.A.	9.60
0-30	719.38	N.A.	20.50
0-40	1186.32	N.A.	33.80
0-60	2155.03	N.A.	61.30
0-80	2838.38	N.A.	80.80
0-90	3014.87	N.A.	85.80
10-90	2928.14	N.A.	83.30
20-40	849.33	N.A.	24.20
20-50	1346.25	N.A.	38.30
40-70	1365.74	N.A.	38.90
60-80	683.35	N.A.	19.40
70-80	286.32	N.A.	8.10
80-90	176.49	N.A.	5.00
90-110	259.94	N.A.	7.40
90-120	361.93	N.A.	10.30
90-130	428.91	N.A.	12.20
90-150	482.77	N.A.	13.70
90-180	499.35	N.A.	14.20
110-180	239.41	N.A.	6.80
0-180	3514.22	N.A.	100.00

## Model Tested: EZT-FT15-2FA-1000-B2-35K8-UNV-DM-W

### Photometric Curve

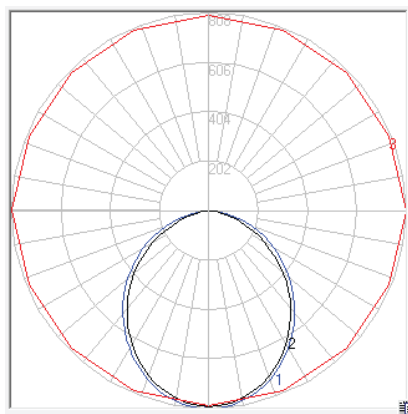

**Length: 2ft**  
**Lumens/ft: 1001.3**  
**Total Lumens: 2002.6**  
**Input Watts: 19.3 W**  
**Efficacy: 103.7 lm/W**

### Candela Distribution

#### Luminance Data [cd/sq.m]

Angle In Degrees	Average 0-Deg	Average 45-Deg	Average 90-Deg
45	37354	36186	35171
55	34999	33432	31034
65	31947	29011	25177
75	26198	20899	15092
85	14695	5104	3016

### Wattage/ft

Lumens/ft	Watts/ft
300	2.89W
400	3.86W
500	4.82W
750	7.23W
850	8.19W
1000	9.64W

### Zonal Lumens

Zone	Lumens	%Lamp	%Fixt
0-20	288.26	N.A.	14.40
0-30	602.30	N.A.	30.10
0-40	968.81	N.A.	48.40
0-60	1652.81	N.A.	82.50
0-80	1985.21	N.A.	99.10
0-90	2003.25	N.A.	100.00
10-90	1927.84	N.A.	96.20
20-40	680.55	N.A.	34.00
20-50	1047.89	N.A.	52.30
40-70	908.30	N.A.	45.30
60-80	332.40	N.A.	16.60
70-80	108.10	N.A.	5.40
80-90	18.04	N.A.	0.90
90-110	0.00	N.A.	0.00
90-120	0.00	N.A.	0.00
90-130	0.00	N.A.	0.00
90-150	0.00	N.A.	0.00
90-180	0.00	N.A.	0.00
110-180	0.00	N.A.	0.00
0-180	2003.25	N.A.	100.00

## Model Tested: EZT-FT15-2FA-1000-B3-35K8-UNV-DM-W

### Photometric Curve

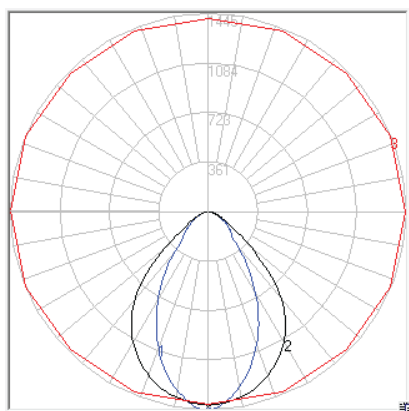

Length: 2ft  
 Lumens/ft: 1,029  
 Total Lumens: 2,059  
 Input Watts: 37.6 W  
 Efficacy: 55 lm/W

### Candela Distribution

#### Luminance Data [cd/sq.m]

Angle In Degrees	Average 0-Deg	Average 45-Deg	Average 90-Deg
45	2519	4092	6535
55	2043	2340	3089
65	1568	1725	1684
75	1114	1003	932
85	679	210	217

### Wattage/ft

Lumens/ft	Watts/ft
300	5.45W
400	7.27W
500	9.1W
750	13.63W
850	15.45W
1000	18.18W

### Zonal Lumens

Zone	Lumens	%Lamp	%Fixt
0-20	484.03	N.A.	23.50
0-30	952.13	N.A.	46.20
0-40	1407.78	N.A.	68.40
0-60	1915.99	N.A.	93.00
0-80	2053.18	N.A.	99.70
0-90	2059.49	N.A.	100.00
10-90	1927.39	N.A.	93.60
20-40	923.75	N.A.	44.90
20-50	1249.67	N.A.	60.70
40-70	605.23	N.A.	29.40
60-80	137.19	N.A.	6.70
70-80	40.17	N.A.	2.00
80-90	6.31	N.A.	0.30
90-110	0.00	N.A.	0.00
90-120	0.00	N.A.	0.00
90-130	0.00	N.A.	0.00
90-150	0.00	N.A.	0.00
90-180	0.00	N.A.	0.00
110-180	0.00	N.A.	0.00
0-180	2059.49	N.A.	100.00

## Model Tested: EZT-FT15-4FA-1000-B4-35K8-UNV-DM-W

### Photometric Curve

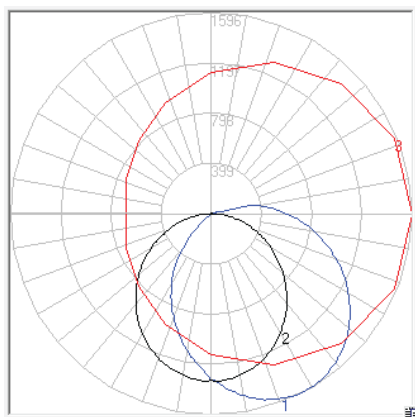

Length: 4ft  
 Lumens/ft: 1,060  
 Total Lumens: 4240  
 Input Watts: 38 W  
 Efficacy: 112 lm/W

### Candela Distribution

#### Luminance Data [cd/sq.m]

Angle In Degrees	Average 0-Deg	Average 45-Deg	Average 90-Deg
45	34501	34746	38214
55	31680	31862	36148
65	28650	28761	33673
75	25368	25232	29922
85	21552	20896	21229

### Wattage/ft

Lumens/ft	Watts/ft
300	2.69W
400	3.58W
500	4.48W
750	6.72W
850	7.62W
1000	8.96W

### Zonal Lumens

Zone	Lumens	%Lamp	%Fixt
0-20	484.53	N.A.	11.40
0-30	1025.77	N.A.	24.20
0-40	1672.11	N.A.	39.40
0-60	2918.39	N.A.	68.80
0-80	3794.92	N.A.	89.50
0-90	4056.33	N.A.	95.70
10-90	3930.77	N.A.	92.70
20-40	1187.58	N.A.	28.00
20-50	1844.36	N.A.	43.50
40-70	1741.43	N.A.	41.10
60-80	876.53	N.A.	20.70
70-80	381.38	N.A.	9.00
80-90	261.41	N.A.	6.20
90-110	173.36	N.A.	4.10
90-120	176.45	N.A.	4.20
90-130	177.87	N.A.	4.20
90-150	180.85	N.A.	4.30
90-180	183.37	N.A.	4.30
110-180	10.01	N.A.	0.20
0-180	4239.7	N.A.	100.00