



Project: _____

Type: _____

Notes: _____

EZT | The EZT System, with multiple lensing options, provides an EZT and versatile way to integrate lines or shapes of light into a T-Grid or drywall ceiling. Create unique layouts by forming shapes like squares, rectangles, L's, or straight lengths with no limitation to main or cross tbars as the fixture simply fastens to the bottom of any grid system or magnetically mounts to drywall ceilings. Also available for pendant mounting.



Ordering Guide

| EZTX | | | | | | | |
|---------|-------|--------------|--|-----|---------------------------------|------|------------|
| ARON ID | | CEILING TYPE | LENGTH | | LUMENS/FT | | |
| EZT1 | EZTV1 | F9 | Flat 9/16" Tbars w/ Flat Acoustical Panel | 2FA | 2FT | 300 | 300 lm/ft |
| | | F15 | Flat 15/16" Tbars w/ Flat Acoustical Panel | 4FA | 4FT | 400 | 400 lm/ft |
| | | FT9 | Flat 9/16" Tbars w/ Regular Acoustical Panel | 6FA | 6FT | 500 | 500 lm/ft |
| | | FT15 | Flat 15/16" Tbars w/ Regular Acoustical Panel | 8FA | 8FT | 750 | 750 lm/ft |
| | | SS | Dimensional 9/16" Bolt Slot Tbars | X | 2'x2', 4'x4', 2'x4'... | 850 | 850 lm/ft |
| | | GYP | Hard Lid Ceiling Surface Mount - Magnet Mounting | C | Continuous Run: *1ft Increments | 1000 | 1000 lm/ft |
| | | FM | T-Grid - Magnet Mounting | | | | |
| | | FTM | Regular Tile - Magnet Mounting | | | | |
| | | WS | Wood Slat - Magnet Mounting | | | | |
| | | | | | | | |
| | | | | | | | |
| | | | | | | | |
| | | | | | | | |
| | | | | | | | |
| | | | | | | | |
| | | | | | | | |
| | | | | | | | |
| | | | | | | | |
| | | | | | | | |
| | | | | | | | |
| | | | | | | | |
| | | | | | | | |
| | | | | | | | |
| | | | | | | | |
| | | | | | | | |
| | | | | | | | |
| | | | | | | | |
| | | | | | | | |
| | | | | | | | |
| | | | | | | | |
| | | | | | | | |
| | | | | | | | |
| | | | | | | | |
| | | | | | | | |
| | | | | | | | |
| | | | | | | | |
| | | | | | | | |
| | | | | | | | |
| | | | | | | | |
| | | | | | | | |
| | | | | | | | |
| | | | | | | | |
| | | | | | | | |
| | | | | | | | |
| | | | | | | | |
| | | | | | | | |
| | | | | | | | |
| | | | | | | | |
| | | | | | | | |
| | | | | | | | |
| | | | | | | | |
| | | | | | | | |
| | | | | | | | |
| | | | | | | | |
| | | | | | | | |
| | | | | | | | |
| | | | | | | | |
| | | | | | | | |
| | | | | | | | |
| | | | | | | | |
| | | | | | | | |
| | | | | | | | |
| | | | | | | | |
| | | | | | | | |
| | | | | | | | |
| | | | | | | | |
| | | | | | | | |
| | | | | | | | |
| | | | | | | | |
| | | | | | | | |
| | | | | | | | |
| | | | | | | | |
| | | | | | | | |
| | | | | | | | |
| | | | | | | | |
| | | | | | | | |
| | | | | | | | |
| | | | | | | | |
| | | | | | | | |
| | | | | | | | |
| | | | | | | | |
| | | | | | | | |
| | | | | | | | |
| | | | | | | | |
| | | | | | | | |
| | | | | | | | |
| | | | | | | | |
| | | | | | | | |
| | | | | | | | |
| | | | | | | | |
| | | | | | | | |
| | | | | | | | |
| | | | | | | | |
| | | | | | | | |
| | | | | | | | |
| | | | | | | | |
| | | | | | | | |
| | | | | | | | |
| | | | | | | | |
| | | | | | | | |
| | | | | | | | |
| | | | | | | | |
| | | | | | | | |
| | | | | | | | |
| | | | | | | | |
| | | | | | | | |
| | | | | | | | |
| | | | | | | | |
| | | | | | | | |
| | | | | | | | |
| | | | | | | | |
| | | | | | | | |
| | | | | | | | |
| | | | | | | | |
| | | | | | | | |
| | | | | | | | |
| | | | | | | | |
| | | | | | | | |
| | | | | | | | |
| | | | | | | | |
| | | | | | | | |
| | | | | | | | |
| | | | | | | | |
| | | | | | | | |
| | | | | | | | |
| | | | | | | | |
| | | | | | | | |
| | | | | | | | |
| | | | | | | | |
| | | | | | | | |
| | | | | | | | |
| | | | | | | | |
| | | | | | | | |
| | | | | | | | |
| | | | | | | | |
| | | | | | | | |
| | | | | | | | |
| | | | | | | | |
| | | | | | | | |
| | | | | | | | |
| | | | | | | | |
| | | | | | | | |
| | | | | | | | |
| | | | | | | | |
| | | | | | | | |
| | | | | | | | |
| | | | | | | | |
| | | | | | | | |
| | | | | | | | |
| | | | | | | | |
| | | | | | | | |
| | | | | | | | |
| | | | | | | | |
| | | | | | | | |
| | | | | | | | |
| | | | | | | | |
| | | | | | | | |
| | | | | | | | |
| | | | | | | | |
| | | | | | | | |
| | | | | | | | |
| | | | | | | | |
| | | | | | | | |

| | | UNV | | | | | | | |
|------|-------------------|-------------|---------------|---------|----------|---|--|---------------------|----------------|
| BEAM | | COLOR / CRI | | VOLTAGE | | DRIVER | | ACCESSORIES/RATINGS | |
| B1 | 3 Sided Diffusion | 30K8 | 3000K - 80CRI | UNV | 120-277V | DM | Factory 0-10V, Dim 1% | E5W | 5W EM Battery |
| B2 | Direct Only | 30K9 | 3000K - 90CRI | 347 | 347 V | BT | Bluetooth | E10W | 10W EM Battery |
| B3 | Louvers | 35K8 | 3500K - 80CRI | | | ELD | EldoLED .1% Dimming | | |
| B4 | Wallwash | 35K9 | 3500K - 90CRI | | | | *contact factory for other driver, dimming and control options | | |
| | | 40K8 | 4000K - 80CRI | | | | | | |
| | | 40K9 | 4000K - 90CRI | | | | | | |
| | | TW | Tunable White | | | | | | |
| | | | | | | **See Page 5 for Bluetooth Information. Consult Factory | | | |

Dimensions

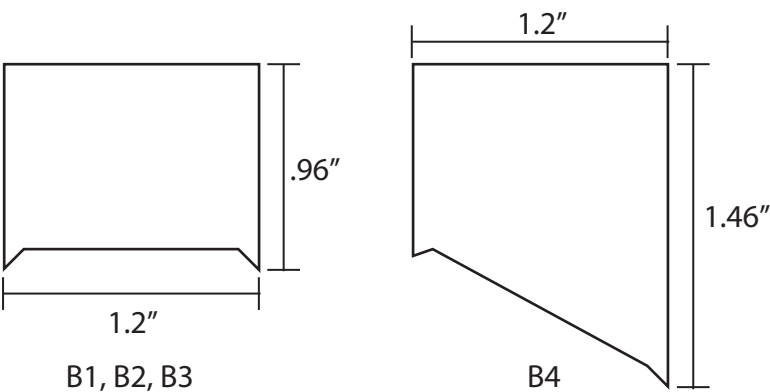

Continuous Runs & Shapes:

Available at any length, with diffuse joiner for continuous line of light.

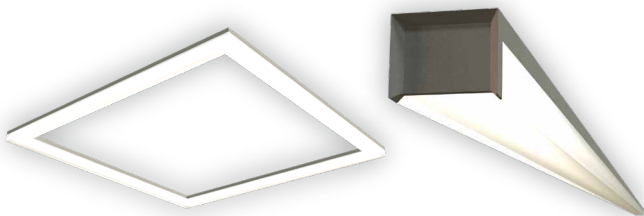

Application Sizes



Cont. Runs
*Increments to the foot
*Contact factory if custom lengths are required

MultiDirectional Shapes
*Contact Factory

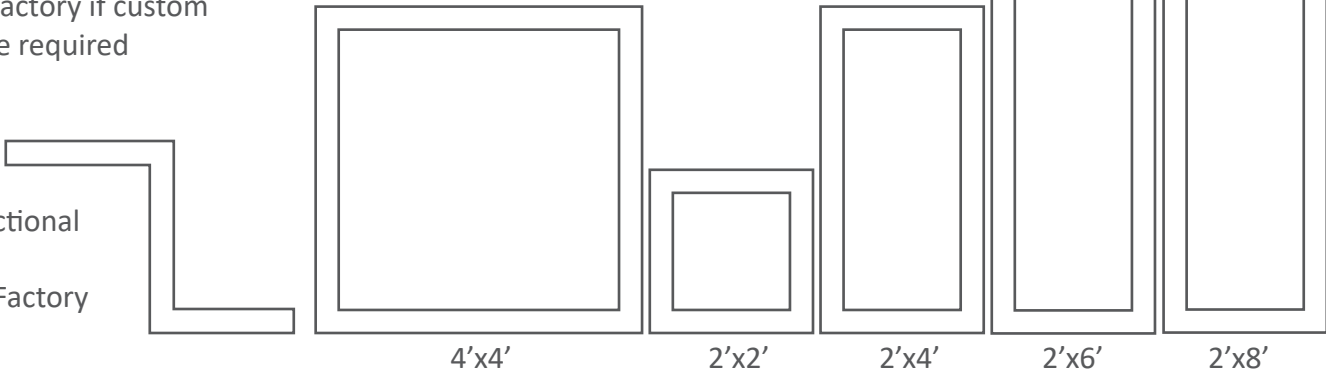

Construction

- Lens: Extruded Volumetric Diffusion Lens
- End Cap: Die Cast Aluminum
- Fixture Housing: Extruded Aluminum, powder coated
- Sheet Metal: Galvanized 18 gauge remote driver box
- Mounting: TGrid Sheet Metal Clip or Drywall Anchors w/ Sheet Metal Attachment Plate
- Joiner: Volumetric Injection Molded Diffuse Material

Optical

- Symmetric Lambertian and Asymmetric Distributions
- Extruded Volumetric Diffusion Lenses
- Minimum 80 or 90 CRI
- 3000K, 3500K, 4000K
- ≤ 3 SDCM

Mounting:

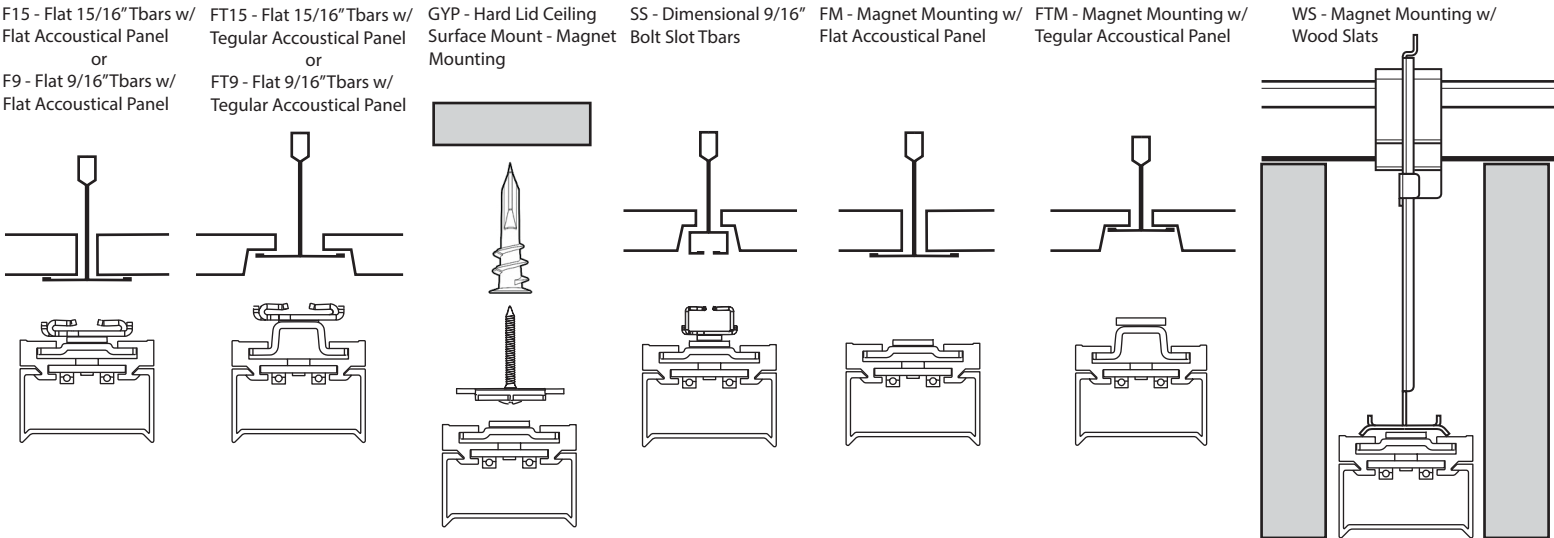

Electrical

- Remote high efficiency driver w/ universal 120-277 input
- 0-10V dimming (1%) standard
- Class 2
- Optional Integral battery pack
- L90: 90,000 Hours
- L70: 185,000 Hours
- Various Control and Driver Options
- *Contact factory

Mechanical Joining



Remote Kit Options

LOW PROFILE REMOTE DRIVER BOX MAX DRIVER SIZE 25W

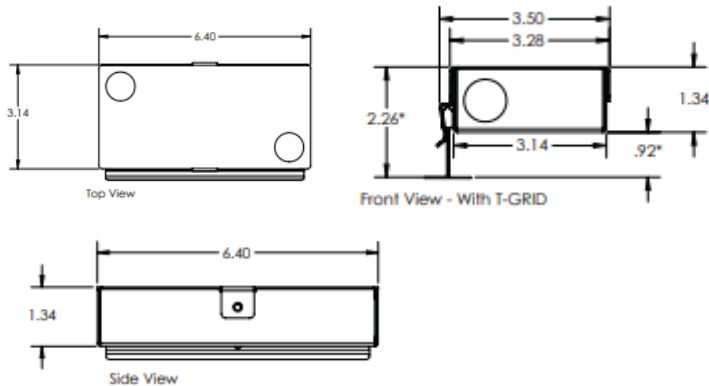

STANDARD REMOTE DRIVER BOX MAX DRIVER SIZE 95W

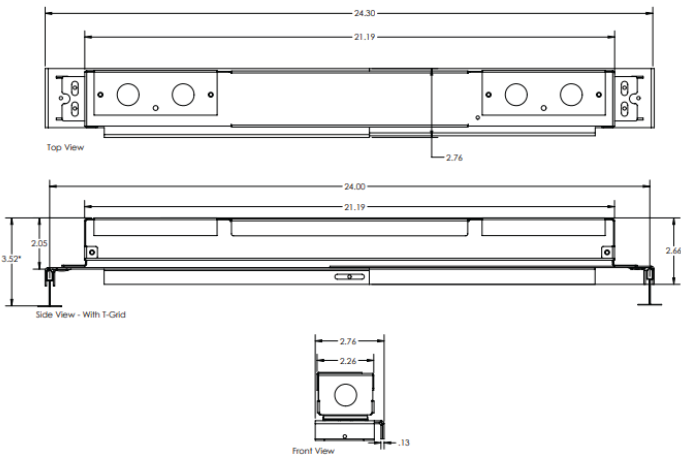

Model Tested: EZT-FT15-4FA-1000-B1-35K8-UNV-DM-W

Photometric Curve

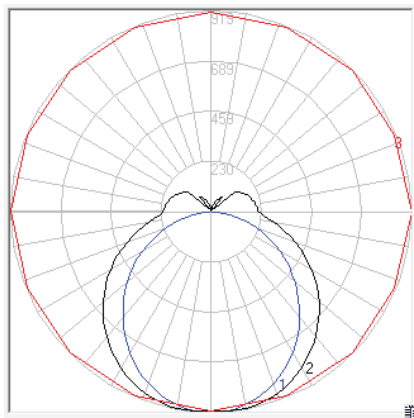

Length: 4ft
Lumens/ft: 878.5
Total Lumens: 3513.8
Input Watts: 27.74 W
Efficacy: 126.7 lm/W

Candela Distribution

Luminance Data [cd/sq.m]

| Angle In Degrees | Average 0-Deg | Average 45-Deg | Average 90-Deg |
|------------------|---------------|----------------|----------------|
| 45 | 21303 | 18184 | 17680 |
| 55 | 19967 | 16537 | 16175 |
| 65 | 18097 | 14741 | 14545 |
| 75 | 14326 | 12483 | 12653 |
| 85 | 7935 | 10234 | 11172 |

Wattage/ft

| Lumens/ft | Watts/ft |
|-----------|----------|
| 300 | 2.37W |
| 400 | 3.16W |
| 500 | 3.95W |
| 750 | 5.92W |
| 850 | 6.71W |
| 1000 | 7.89W |

Zonal Lumens

| Zone | Lumens | %Lamp | %Fixt |
|---------|---------|-------|--------|
| 0-20 | 336.99 | N.A. | 9.60 |
| 0-30 | 719.38 | N.A. | 20.50 |
| 0-40 | 1186.32 | N.A. | 33.80 |
| 0-60 | 2155.03 | N.A. | 61.30 |
| 0-80 | 2838.38 | N.A. | 80.80 |
| 0-90 | 3014.87 | N.A. | 85.80 |
| 10-90 | 2928.14 | N.A. | 83.30 |
| 20-40 | 849.33 | N.A. | 24.20 |
| 20-50 | 1346.25 | N.A. | 38.30 |
| 40-70 | 1365.74 | N.A. | 38.90 |
| 60-80 | 683.35 | N.A. | 19.40 |
| 70-80 | 286.32 | N.A. | 8.10 |
| 80-90 | 176.49 | N.A. | 5.00 |
| 90-110 | 259.94 | N.A. | 7.40 |
| 90-120 | 361.93 | N.A. | 10.30 |
| 90-130 | 428.91 | N.A. | 12.20 |
| 90-150 | 482.77 | N.A. | 13.70 |
| 90-180 | 499.35 | N.A. | 14.20 |
| 110-180 | 239.41 | N.A. | 6.80 |
| 0-180 | 3514.22 | N.A. | 100.00 |

Model Tested: EZT-FT15-2FA-1000-B2-35K8-UNV-DM-W

Photometric Curve

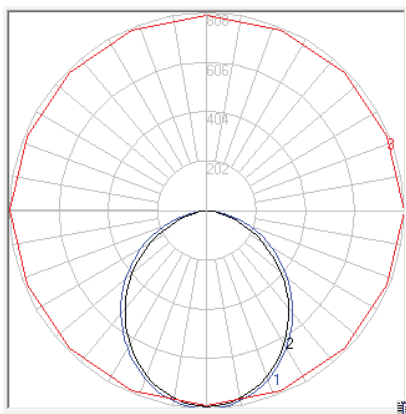

Length: 2ft
Lumens/ft: 1001.3
Total Lumens: 2002.6
Input Watts: 19.3 W
Efficacy: 103.7 lm/W

Candela Distribution

Luminance Data [cd/sq.m]

| Angle In Degrees | Average 0-Deg | Average 45-Deg | Average 90-Deg |
|------------------|---------------|----------------|----------------|
| 45 | 37354 | 36186 | 35171 |
| 55 | 34999 | 33432 | 31034 |
| 65 | 31947 | 29011 | 25177 |
| 75 | 26198 | 20899 | 15092 |
| 85 | 14695 | 5104 | 3016 |

Wattage/ft

| Lumens/ft | Watts/ft |
|-----------|----------|
| 300 | 2.89W |
| 400 | 3.86W |
| 500 | 4.82W |
| 750 | 7.23W |
| 850 | 8.19W |
| 1000 | 9.64W |

Zonal Lumens

| Zone | Lumens | %Lamp | %Fixt |
|---------|---------|-------|--------|
| 0-20 | 288.26 | N.A. | 14.40 |
| 0-30 | 602.30 | N.A. | 30.10 |
| 0-40 | 968.81 | N.A. | 48.40 |
| 0-60 | 1652.81 | N.A. | 82.50 |
| 0-80 | 1985.21 | N.A. | 99.10 |
| 0-90 | 2003.25 | N.A. | 100.00 |
| 10-90 | 1927.84 | N.A. | 96.20 |
| 20-40 | 680.55 | N.A. | 34.00 |
| 20-50 | 1047.89 | N.A. | 52.30 |
| 40-70 | 908.30 | N.A. | 45.30 |
| 60-80 | 332.40 | N.A. | 16.60 |
| 70-80 | 108.10 | N.A. | 5.40 |
| 80-90 | 18.04 | N.A. | 0.90 |
| 90-110 | 0.00 | N.A. | 0.00 |
| 90-120 | 0.00 | N.A. | 0.00 |
| 90-130 | 0.00 | N.A. | 0.00 |
| 90-150 | 0.00 | N.A. | 0.00 |
| 90-180 | 0.00 | N.A. | 0.00 |
| 110-180 | 0.00 | N.A. | 0.00 |
| 0-180 | 2003.25 | N.A. | 100.00 |

Model Tested: EZT-FT15-2FA-1000-B3-35K8-UNV-DM-W

Photometric Curve

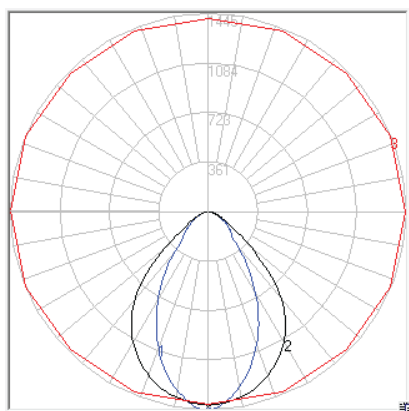

Length: 2ft
 Lumens/ft: 1,029
 Total Lumens: 2,059
 Input Watts: 37.6 W
 Efficacy: 55 lm/W

Candela Distribution

Luminance Data [cd/sq.m]

| Angle In Degrees | Average 0-Deg | Average 45-Deg | Average 90-Deg |
|------------------|---------------|----------------|----------------|
| 45 | 2519 | 4092 | 6535 |
| 55 | 2043 | 2340 | 3089 |
| 65 | 1568 | 1725 | 1684 |
| 75 | 1114 | 1003 | 932 |
| 85 | 679 | 210 | 217 |

Wattage/ft

| Lumens/ft | Watts/ft |
|-----------|----------|
| 300 | 5.45W |
| 400 | 7.27W |
| 500 | 9.1W |
| 750 | 13.63W |
| 850 | 15.45W |
| 1000 | 18.18W |

Zonal Lumens

| Zone | Lumens | %Lamp | %Fixt |
|---------|---------|-------|--------|
| 0-20 | 484.03 | N.A. | 23.50 |
| 0-30 | 952.13 | N.A. | 46.20 |
| 0-40 | 1407.78 | N.A. | 68.40 |
| 0-60 | 1915.99 | N.A. | 93.00 |
| 0-80 | 2053.18 | N.A. | 99.70 |
| 0-90 | 2059.49 | N.A. | 100.00 |
| 10-90 | 1927.39 | N.A. | 93.60 |
| 20-40 | 923.75 | N.A. | 44.90 |
| 20-50 | 1249.67 | N.A. | 60.70 |
| 40-70 | 605.23 | N.A. | 29.40 |
| 60-80 | 137.19 | N.A. | 6.70 |
| 70-80 | 40.17 | N.A. | 2.00 |
| 80-90 | 6.31 | N.A. | 0.30 |
| 90-110 | 0.00 | N.A. | 0.00 |
| 90-120 | 0.00 | N.A. | 0.00 |
| 90-130 | 0.00 | N.A. | 0.00 |
| 90-150 | 0.00 | N.A. | 0.00 |
| 90-180 | 0.00 | N.A. | 0.00 |
| 110-180 | 0.00 | N.A. | 0.00 |
| 0-180 | 2059.49 | N.A. | 100.00 |

Model Tested: EZT-FT15-4FA-1000-B4-35K8-UNV-DM-W

Photometric Curve

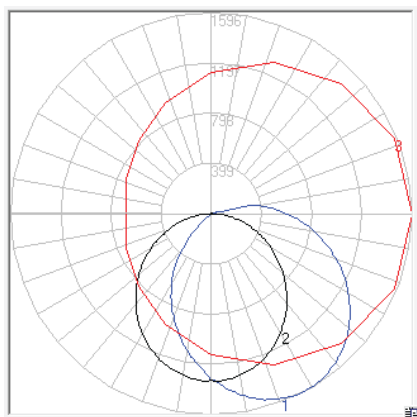

Length: 4ft
 Lumens/ft: 1,060
 Total Lumens: 4240
 Input Watts: 38 W
 Efficacy: 112 lm/W

Candela Distribution

Luminance Data [cd/sq.m]

| Angle In Degrees | Average 0-Deg | Average 45-Deg | Average 90-Deg |
|------------------|---------------|----------------|----------------|
| 45 | 34501 | 34746 | 38214 |
| 55 | 31680 | 31862 | 36148 |
| 65 | 28650 | 28761 | 33673 |
| 75 | 25368 | 25232 | 29922 |
| 85 | 21552 | 20896 | 21229 |

Wattage/ft

| Lumens/ft | Watts/ft |
|-----------|----------|
| 300 | 2.69W |
| 400 | 3.58W |
| 500 | 4.48W |
| 750 | 6.72W |
| 850 | 7.62W |
| 1000 | 8.96W |

Zonal Lumens

| Zone | Lumens | %Lamp | %Fixt |
|---------|---------|-------|--------|
| 0-20 | 484.53 | N.A. | 11.40 |
| 0-30 | 1025.77 | N.A. | 24.20 |
| 0-40 | 1672.11 | N.A. | 39.40 |
| 0-60 | 2918.39 | N.A. | 68.80 |
| 0-80 | 3794.92 | N.A. | 89.50 |
| 0-90 | 4056.33 | N.A. | 95.70 |
| 10-90 | 3930.77 | N.A. | 92.70 |
| 20-40 | 1187.58 | N.A. | 28.00 |
| 20-50 | 1844.36 | N.A. | 43.50 |
| 40-70 | 1741.43 | N.A. | 41.10 |
| 60-80 | 876.53 | N.A. | 20.70 |
| 70-80 | 381.38 | N.A. | 9.00 |
| 80-90 | 261.41 | N.A. | 6.20 |
| 90-110 | 173.36 | N.A. | 4.10 |
| 90-120 | 176.45 | N.A. | 4.20 |
| 90-130 | 177.87 | N.A. | 4.20 |
| 90-150 | 180.85 | N.A. | 4.30 |
| 90-180 | 183.37 | N.A. | 4.30 |
| 110-180 | 10.01 | N.A. | 0.20 |
| 0-180 | 4239.7 | N.A. | 100.00 |